

EXTRAS

50E

www.sebart-shop.com



Silver / Yellow / Blue scheme



Underside scheme



Silver / Yellow / Red scheme

Wing Span: 61 in (1.550 mm)
 Length: 63 in (1.600 mm)
 Wing Area: 768,78 sq in (50,76 dm²)
 Weight (less battery): 5.86 lb (2,66 Kg)
 Weight (with battery): 7.65 lb (3,47 Kg)
 Required radio: 6 or more channels with 4 mini MG digital servos (JR S3411 or S3911)
 Recommended Power Setup
 Motor: Hacker A50-16S
 ESC: Jeti 100A
 Battery: Li-Po 5800-6S
 Propeller: APC 16x10E or 17x8E

50 Class

step 01



Aileron hinges are factory preglued

step 02

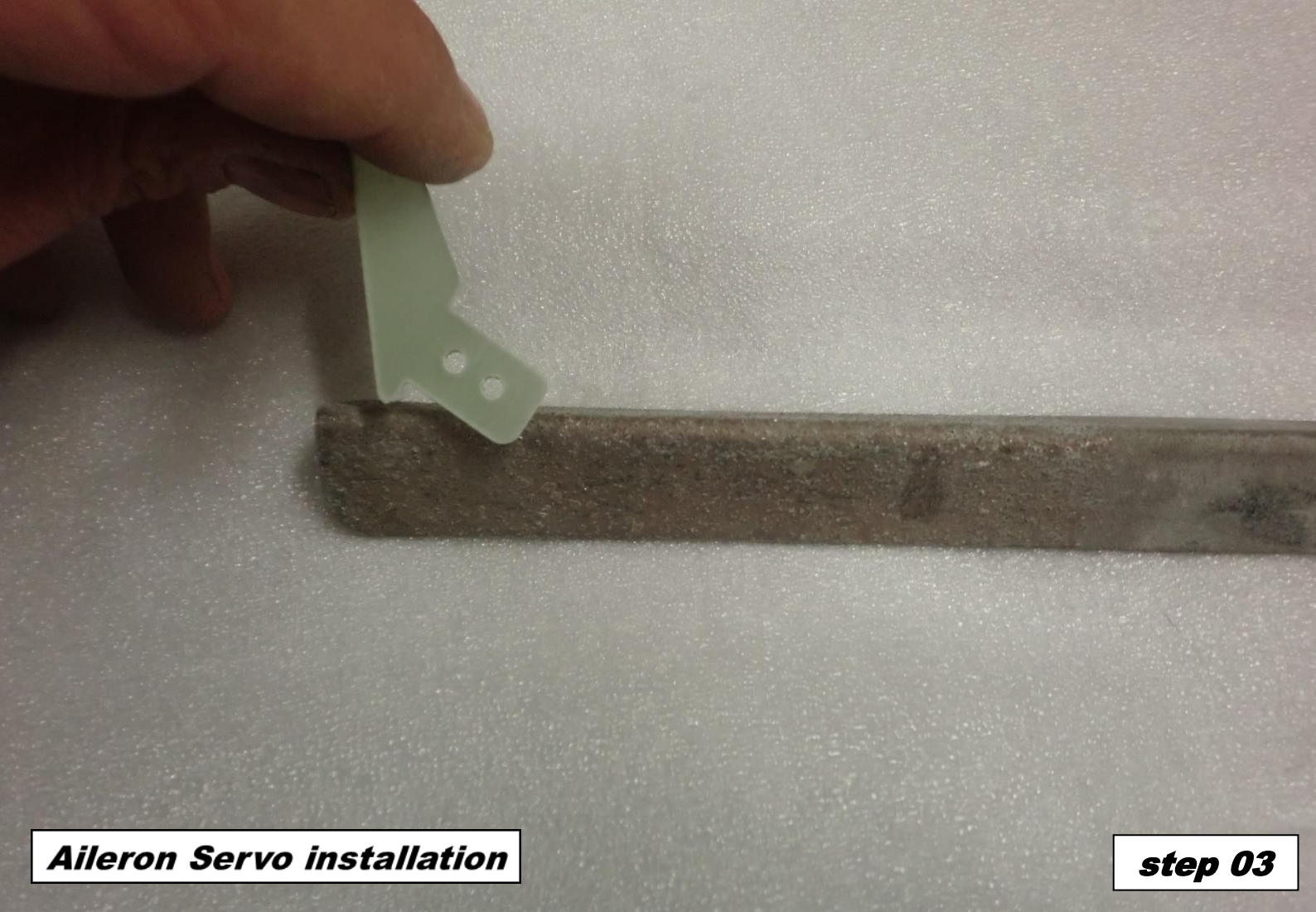

Aileron Servo installation

step 03



Aileron Servo installation

step 04



Aileron Servo installation

step 05



Aileron Servo installation

step 06



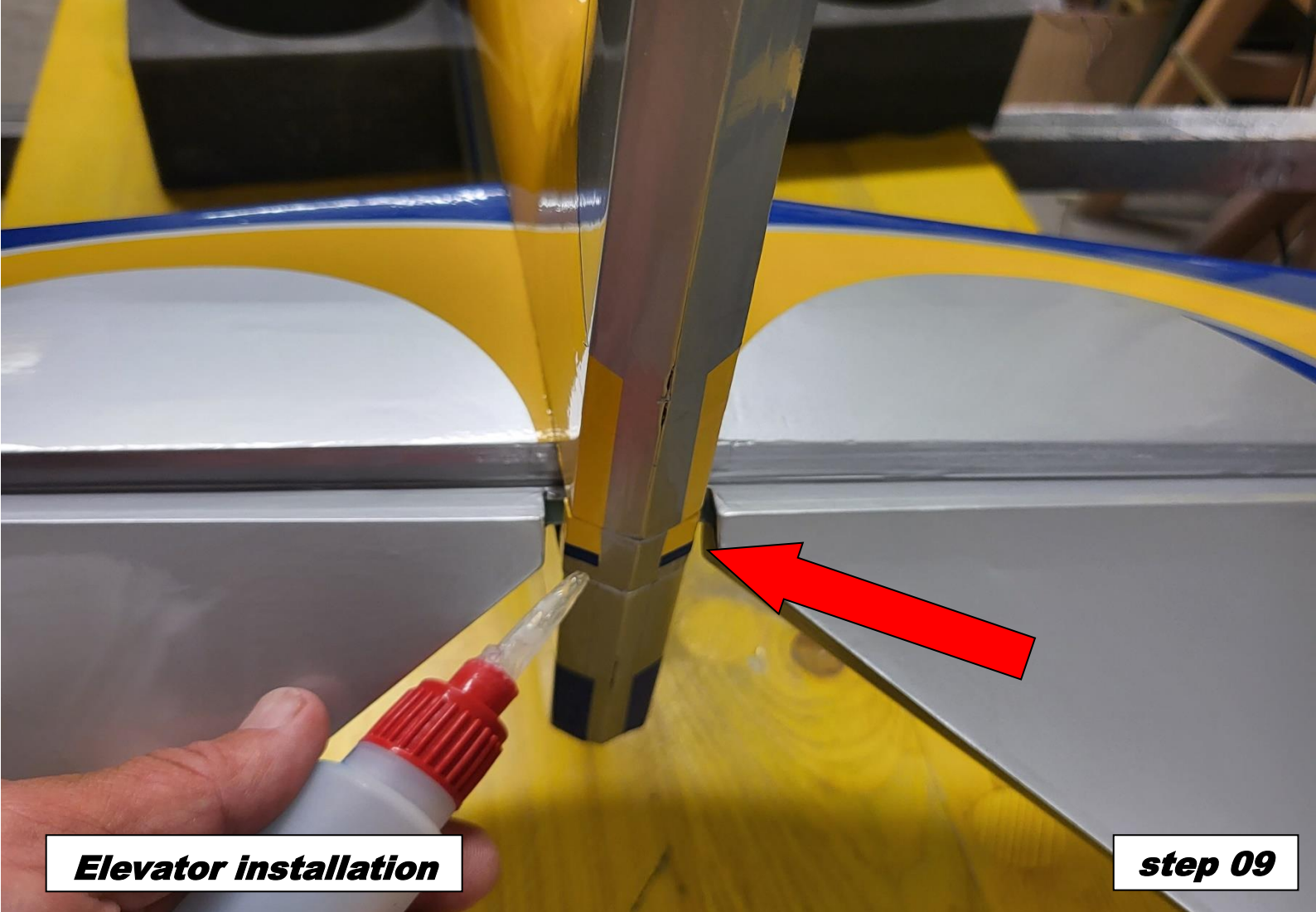

Elevator installation

step 09



Rudder installation

step 10



Rudder installation

step 11



Tail L.gear installation

step 12



Rudder servo installation

step 13

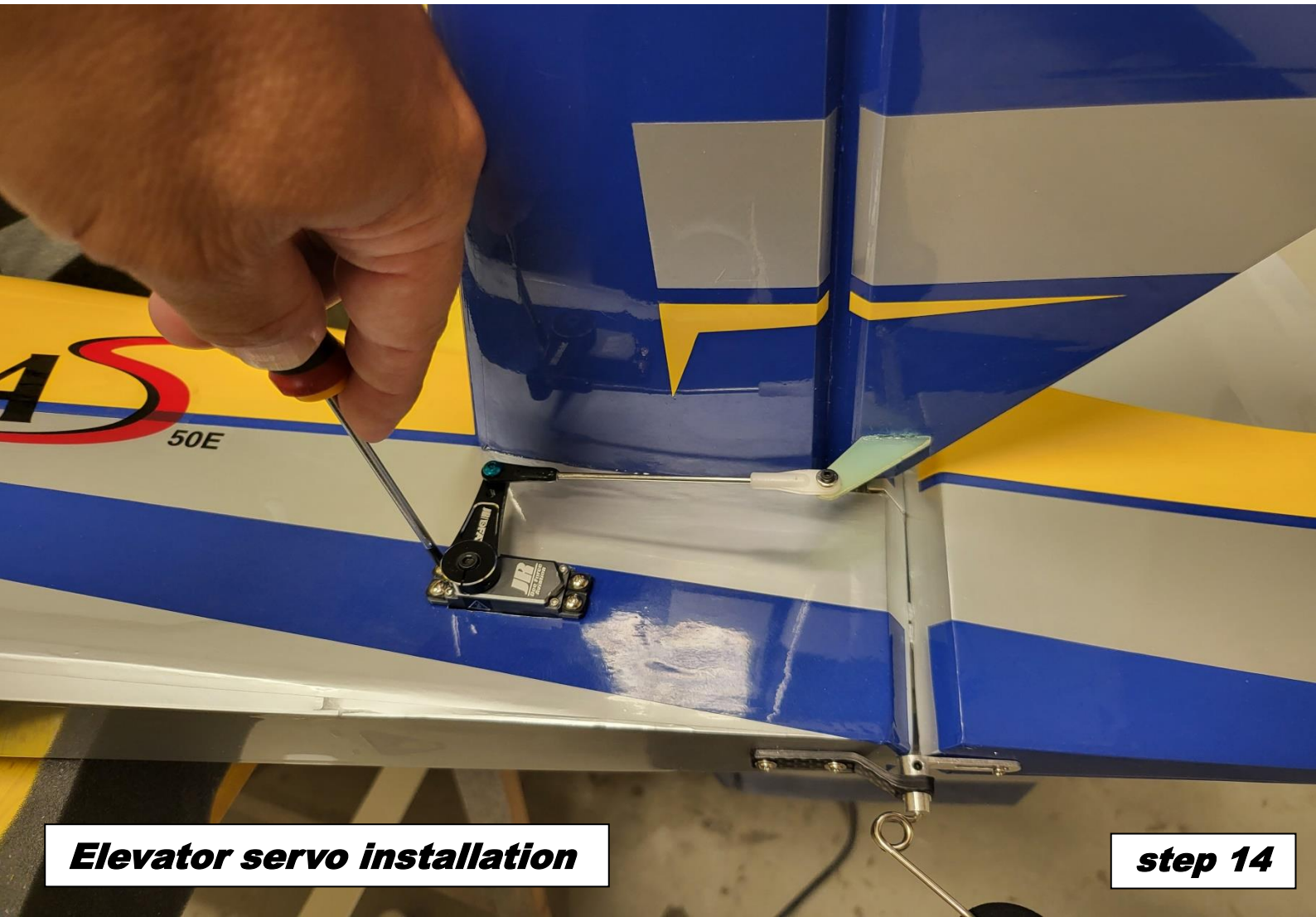

Elevator servo installation

step 14

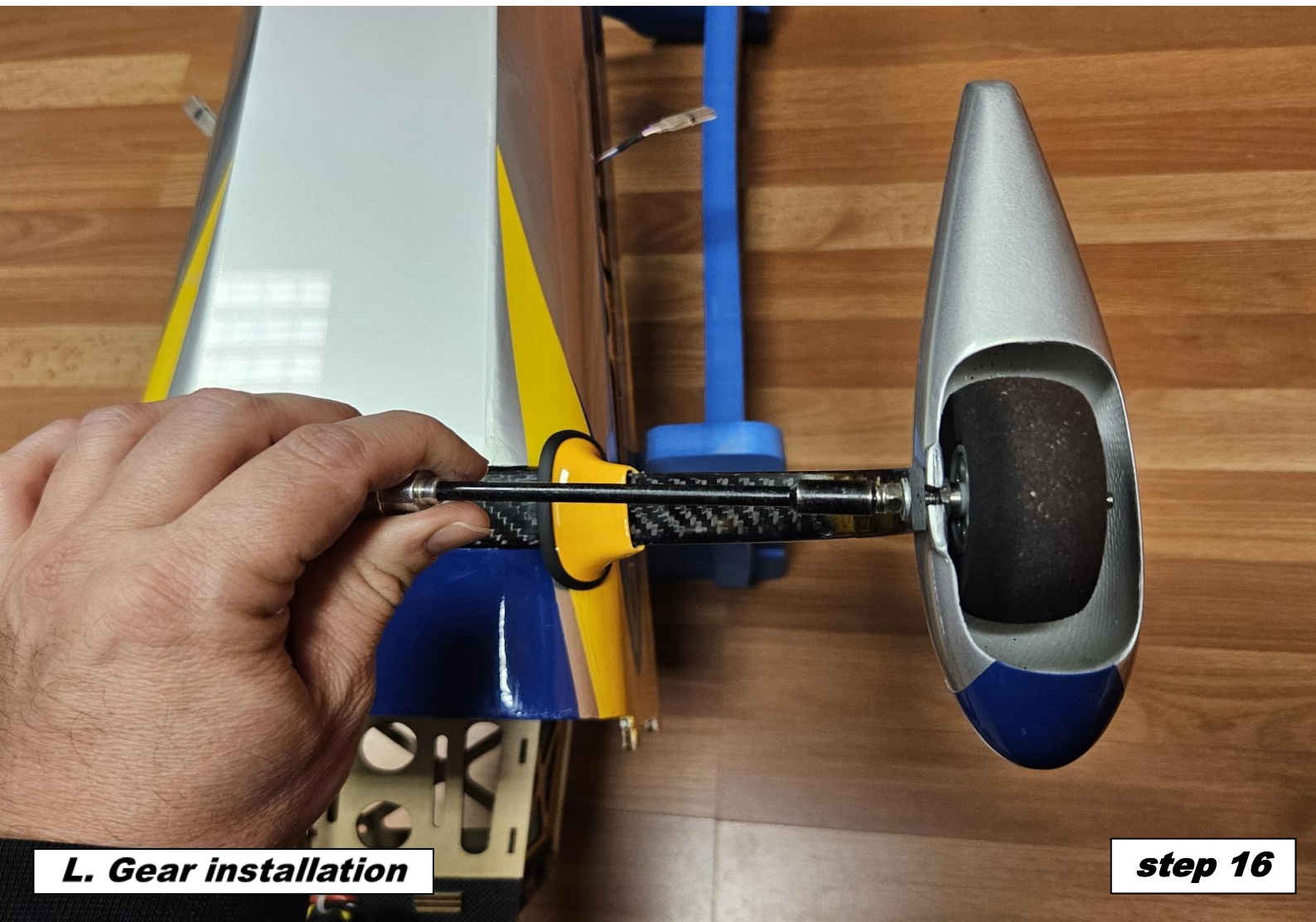



L. Gear installation

step 17



Use silicon to glue

L. Gear installation

step 18

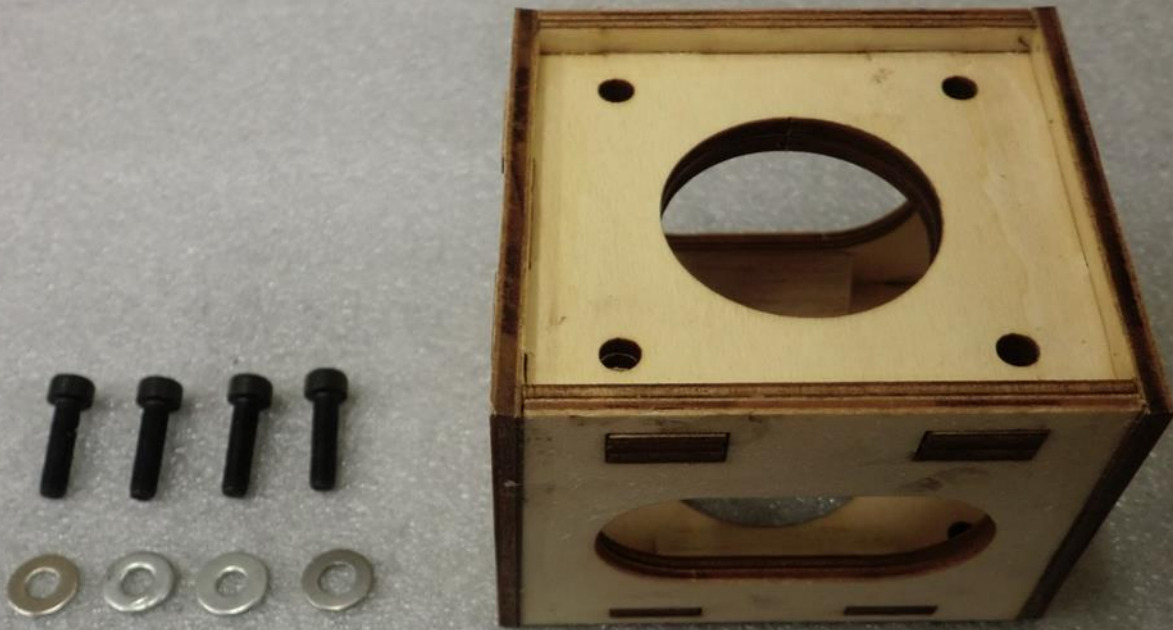

Electric motor installation

step 19

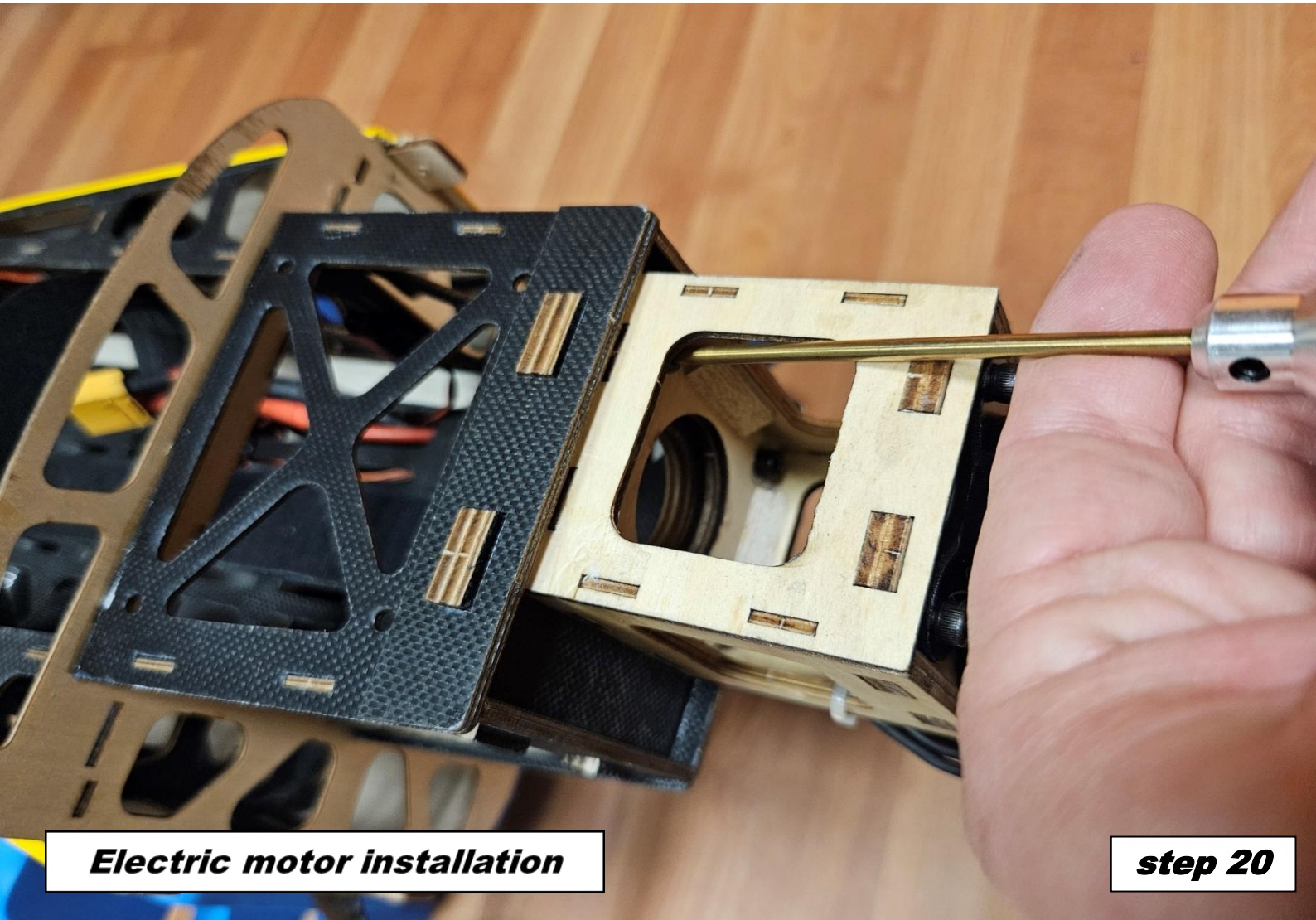

Electric motor installation

step 20



Electric motor installation

step 21

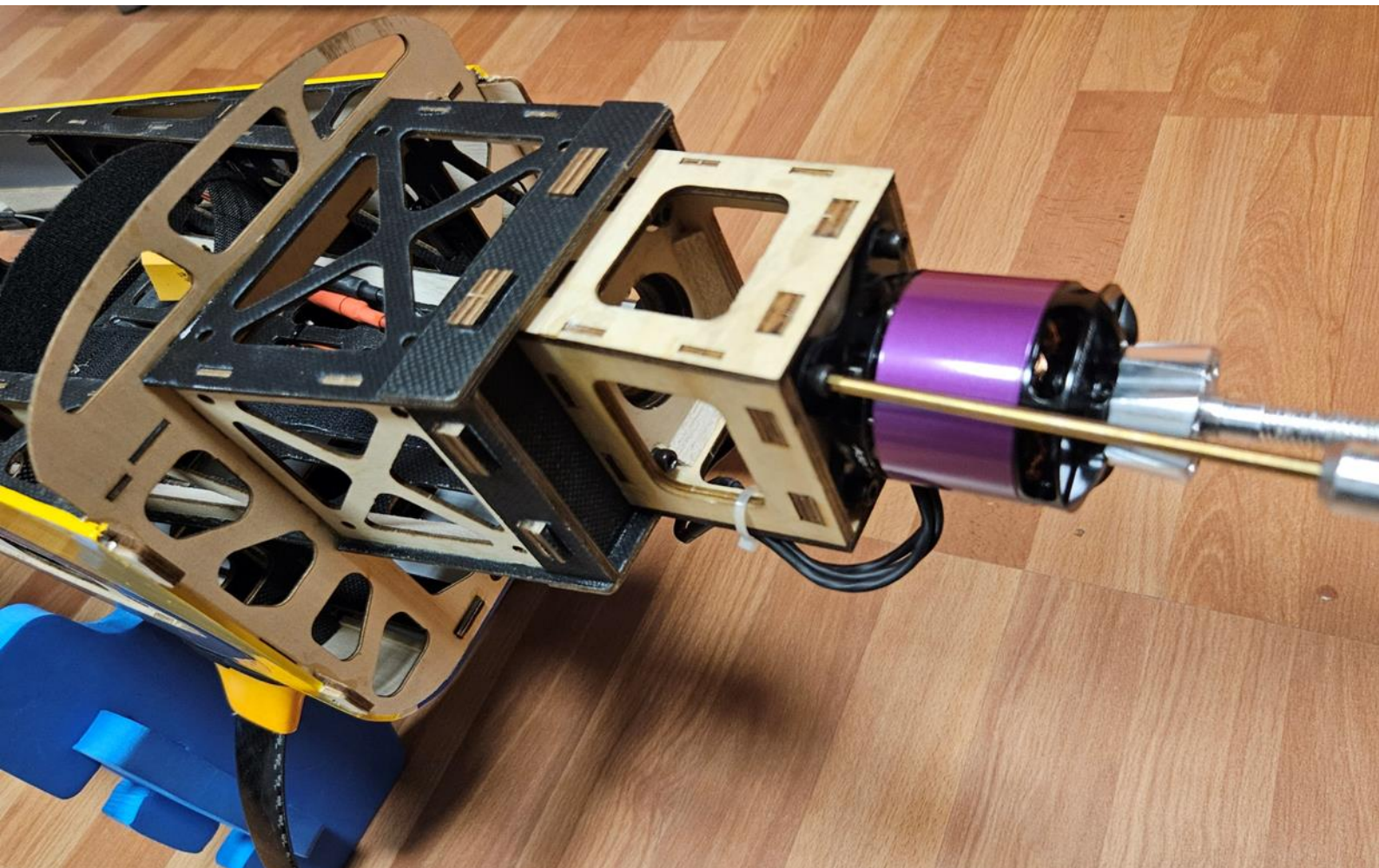

Electric motor installation

step 22

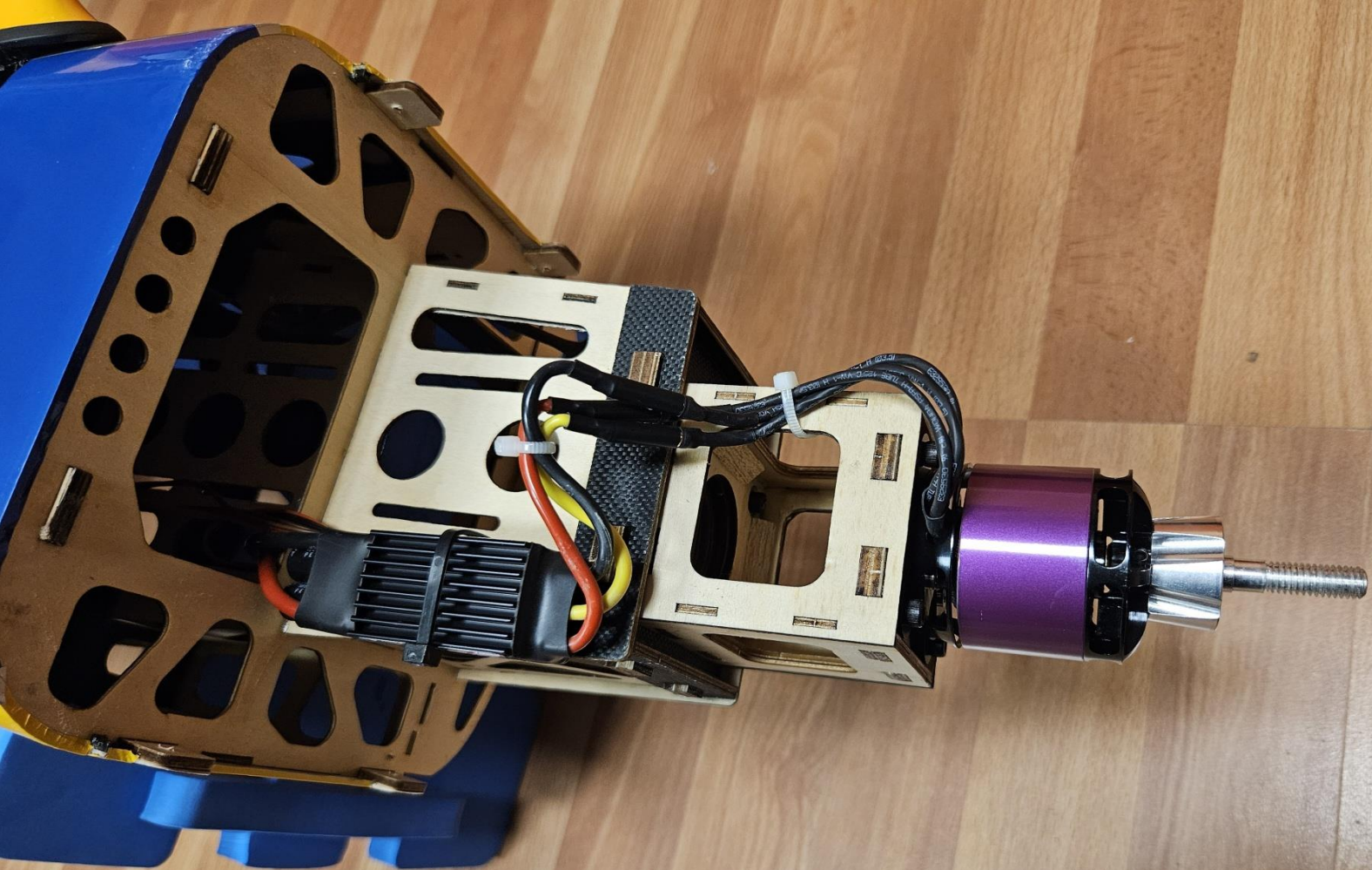

Electric motor installation

step 23

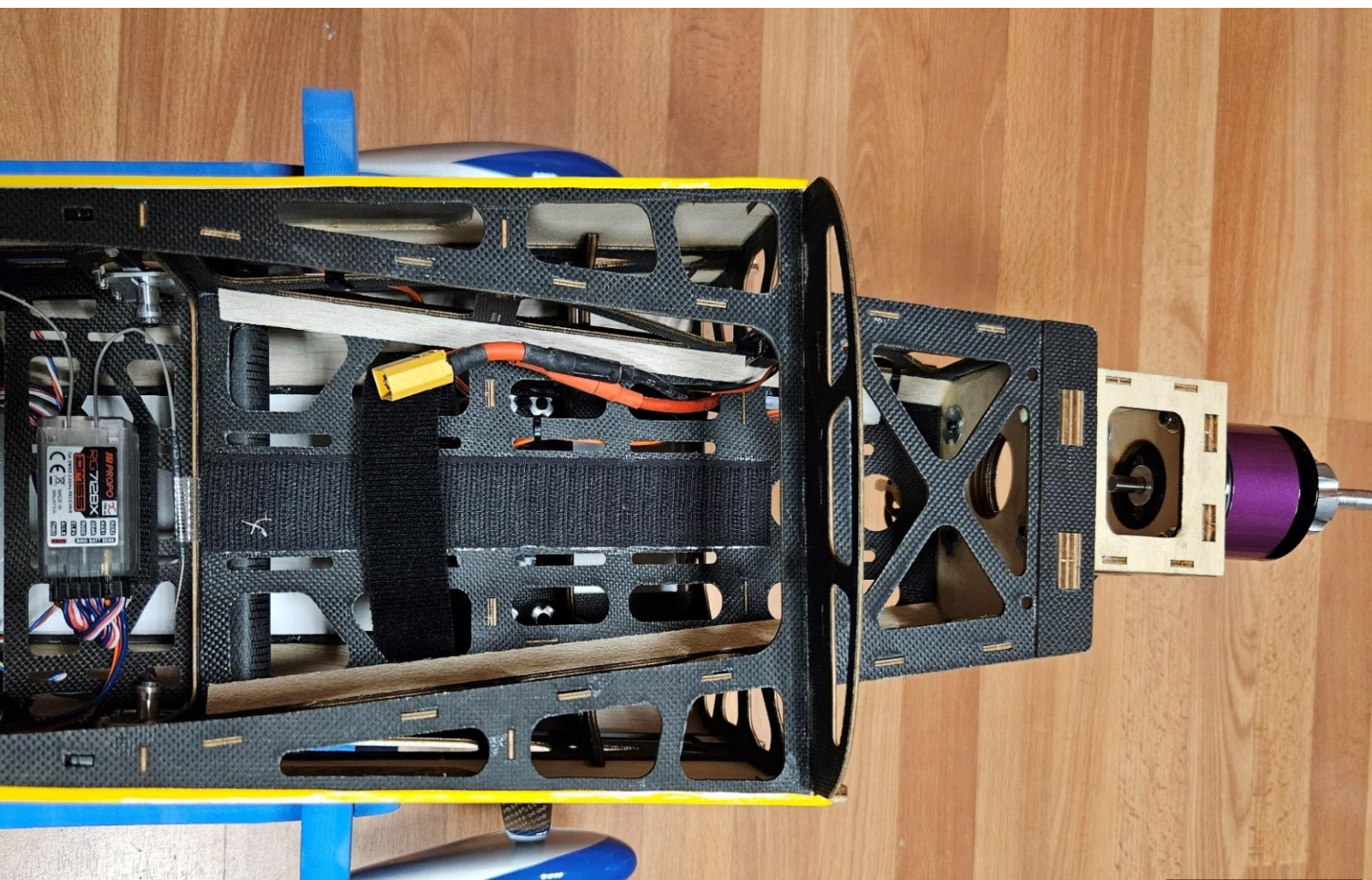

Electric motor installation

step 24





Electric motor installation

step 27

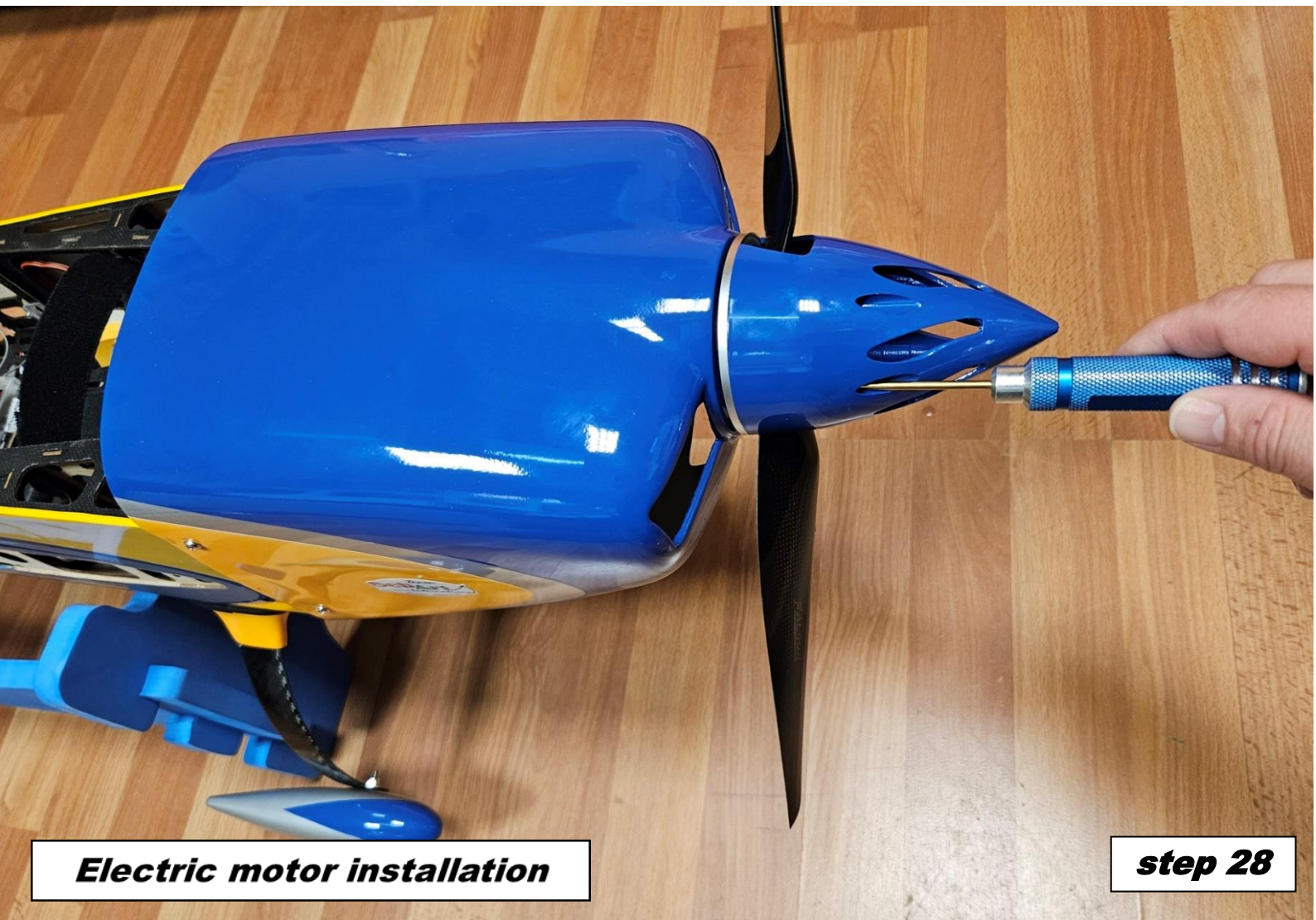

Electric motor installation

step 28

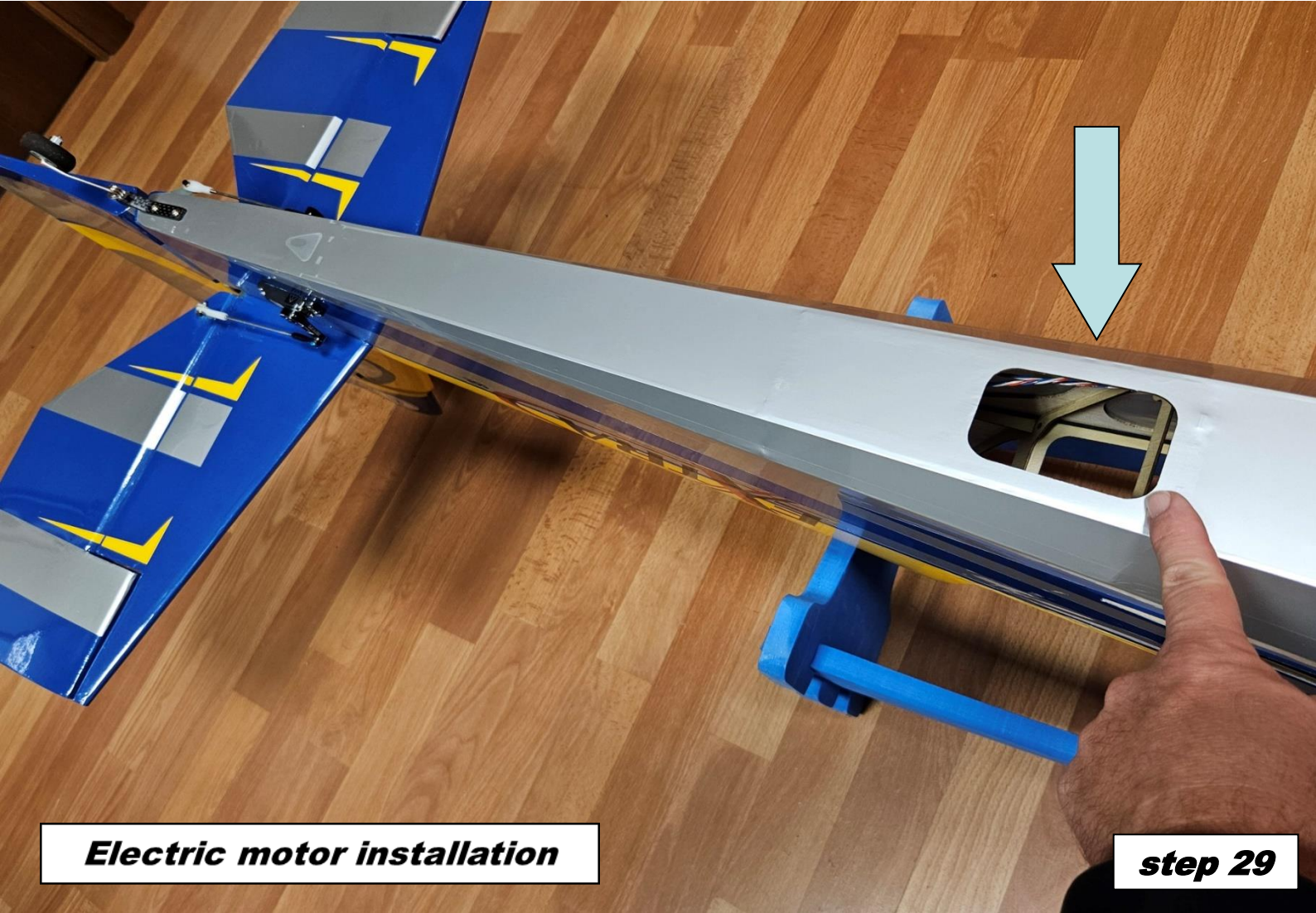

Electric motor installation

step 29



Electric motor installation

step 30





step 33

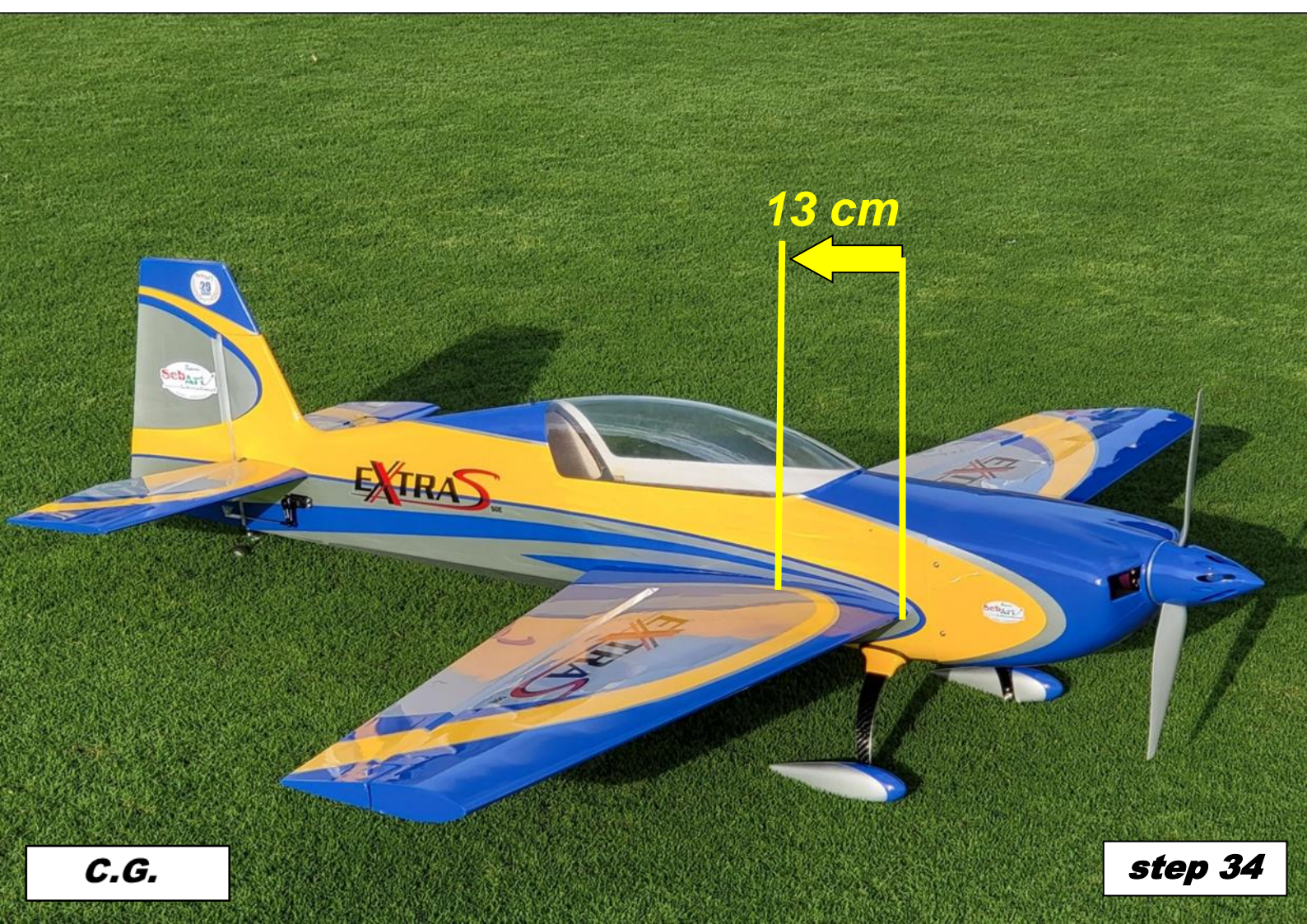

13 cm

C.G.

step 34